

版本 REV.	日期 DATE	ECN NO.	变更内容 DESCRIPTION	制图 DRAWN

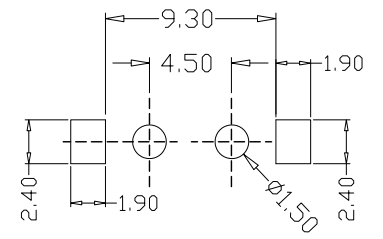
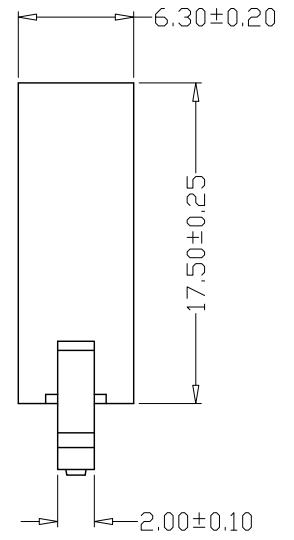
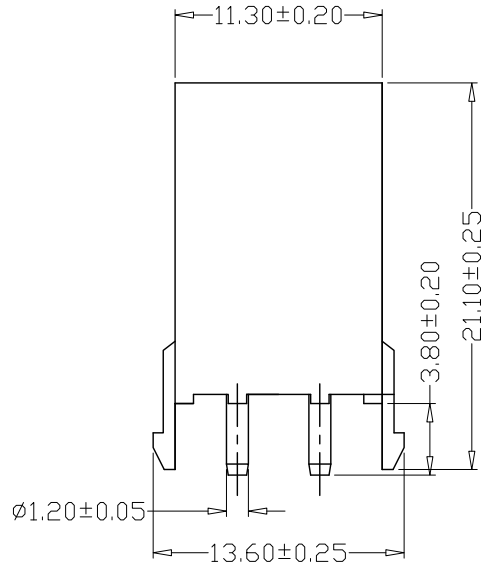
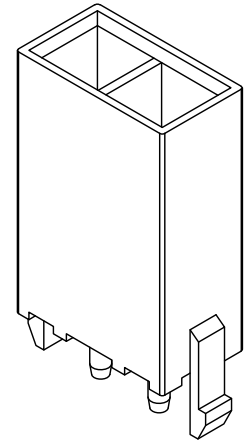
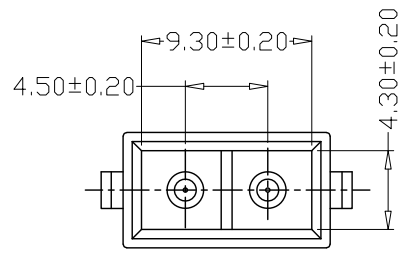

PCB LAYOUT

SPECIFICATIONS

- 1、Current Rating: 5A AC, DC
- 2、Voltage Rating: 250V AC, DC
- 3、Temperatuer Range: -25°C ~ +85°C
- 4、Contact Resistance: 20mΩ Max
- 5、Insulation Resistance: 1000MΩ Min
- 6、Withstanding Voltang: 500V AC/minute
- 7、Material: Wafer PA66, UL94V-0  
PIN Brass Tin-plated

GENREL TOLERANCE		制图 Mapping	张迎春 2022、12、22		料号 PART NO.	A45001-2A		版本 REV.	A	
X.±0.25	X.°±2°	审核 Audit	钱岳生 2022、12、22		品名 TITLE	45001直针 WAFER DIP TYPE		页次 SHEET	1/1	
.X±0.25	.X°±1°		核准 Approved		客户料号 CUTM. NO.					
.XX±0.15	.XX°±0.5°	张名 2022、12、23				YueQing HongYi Electronics Co., Ltd				
.XXX±0.10	.XXX°±0.5°	单位 Units	mm					比例 SCALE		